

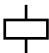





18.21



18.31

EN 60669 - 1 / EN 60669 - 2 - 1				
	18.x1.8.230.0000 U _N (120...230)V AC (50/60 Hz) U _{min} - U _{max} 96 V AC - 253 V AC		18.x1.8.230.0300 U _N (120...230)V AC (50/60 Hz) U _{min} - U _{max} 96 V AC - 253 V AC	
	18.x1.0.024.0300 U _N 24 V AC (50/60 Hz) / DC U _{min} - U _{max} (19.2 V - 26.4 V) AC/DC			
	P 2 V A (50 Hz) / 1 W			
	1 NO (SPST-NO) 10 A 120 V AC 10 A 230 V AC		1 NO (SPST-NO) 10 A 250 V AC	
	AC1 (230 V)	2300 VA	AC1 (230 V)	2500 VA
	AC15 (230 V)	450 VA	AC15 (230 V)	450 VA
	 (120 V AC)	500 W	 (230 V)	1000 W
	(230 V AC)	1000 W		
	(120 V AC)	200 W	(230 V)	350 W
	(230 V AC)	350 W		
	CFL-LED (230 V)	300 W	CFL-LED (230 V)	300 W
	(-10...+50)°C			
IP40				

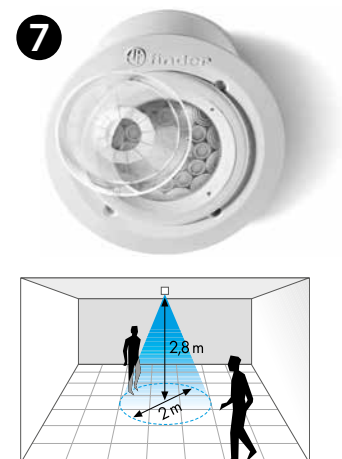
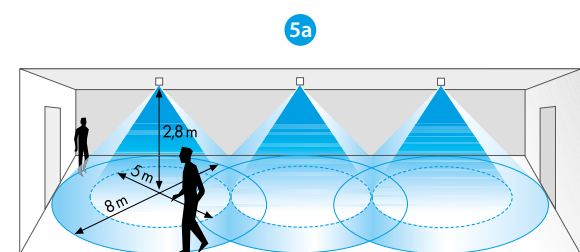
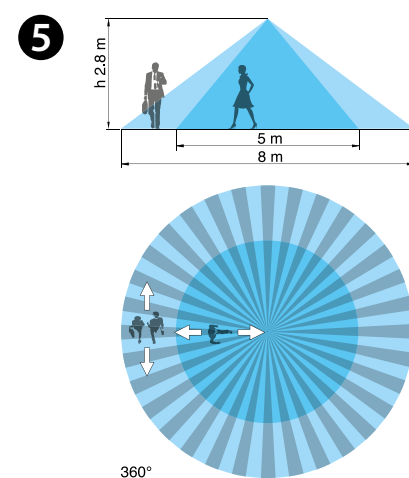
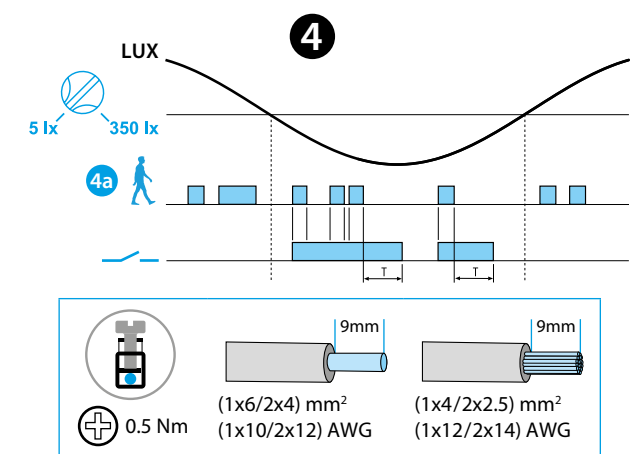
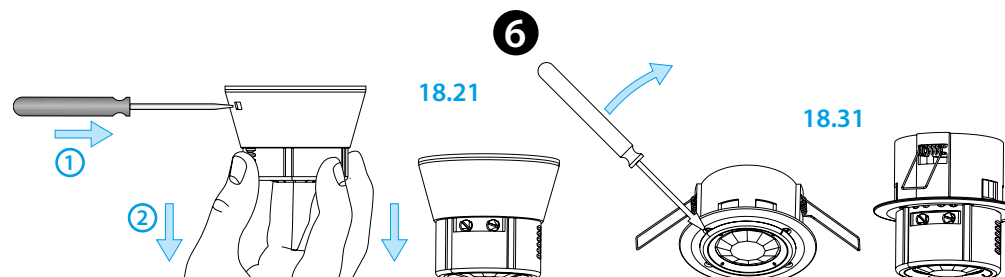
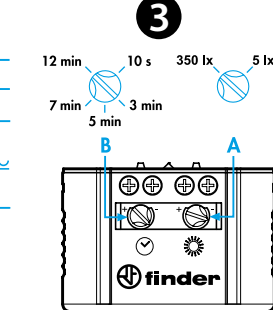
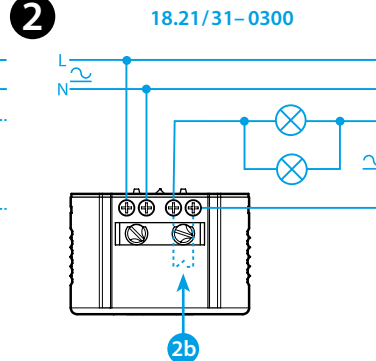
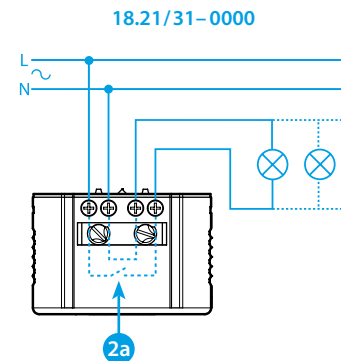
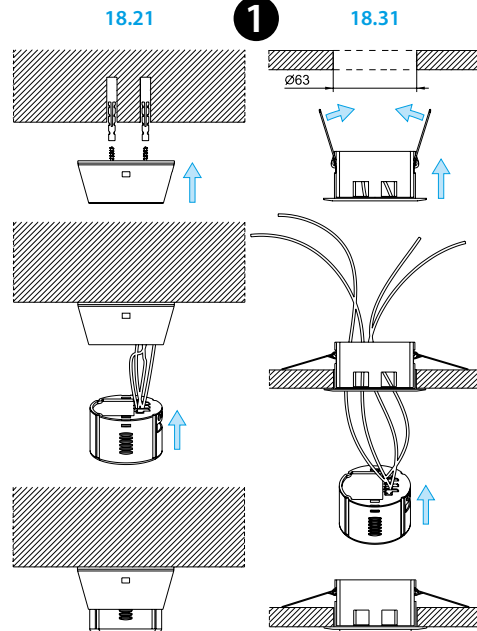

ENGLISH

18.21-18.31
PIR DETECTOR FOR INTERNAL INSTALLATIONS

1 INSTALLATION SEQUENCE

2 CONNECTION DIAGRAM
2a-2b Internal connections

3 SETTINGS

A ambient light intervention threshold (5...350)lx

B output on-pulse time (10s...12min)

NOTE

By adjusting the selector A to the maximum value the PIR will control the contact independent of the ambient light level

4 FUNCTION CHART

4a Detection of movement

Output Contact

5 SIDE VIEW
(Sensing area - Ceiling mounting)

5a Multiple installation

6 DISASSEMBLY

7 ACCESSORIES

NOTE

- Following the initial power-on, and power-on following a power interruption, the detector makes a hardware-software initialisation for approximately 30 seconds

- The versions with supply 24 V AC/DC are not suitable for the connection to a SELV circuit