

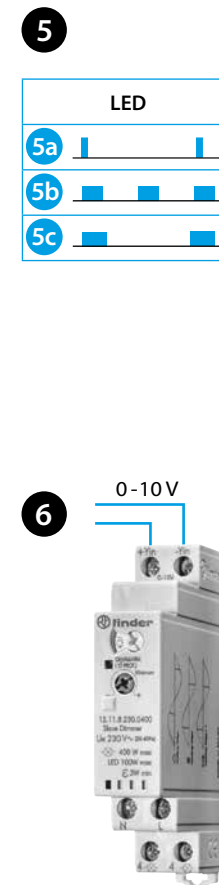

15.10

	15.10.8.230.0010 U_N (110...230)V AC (50/60 Hz) U_{min} 90 V AC U_{max} 253 V AC P 0.5 W
OUT	0 - 10 V (+Y _{out} / -Y _{out}) (35 mA)
	1 NO (SPST-NO) 6 A 230 V AC (2*)
	(-10...+50)°C
	15 (≤ 1 mA)
IP20	

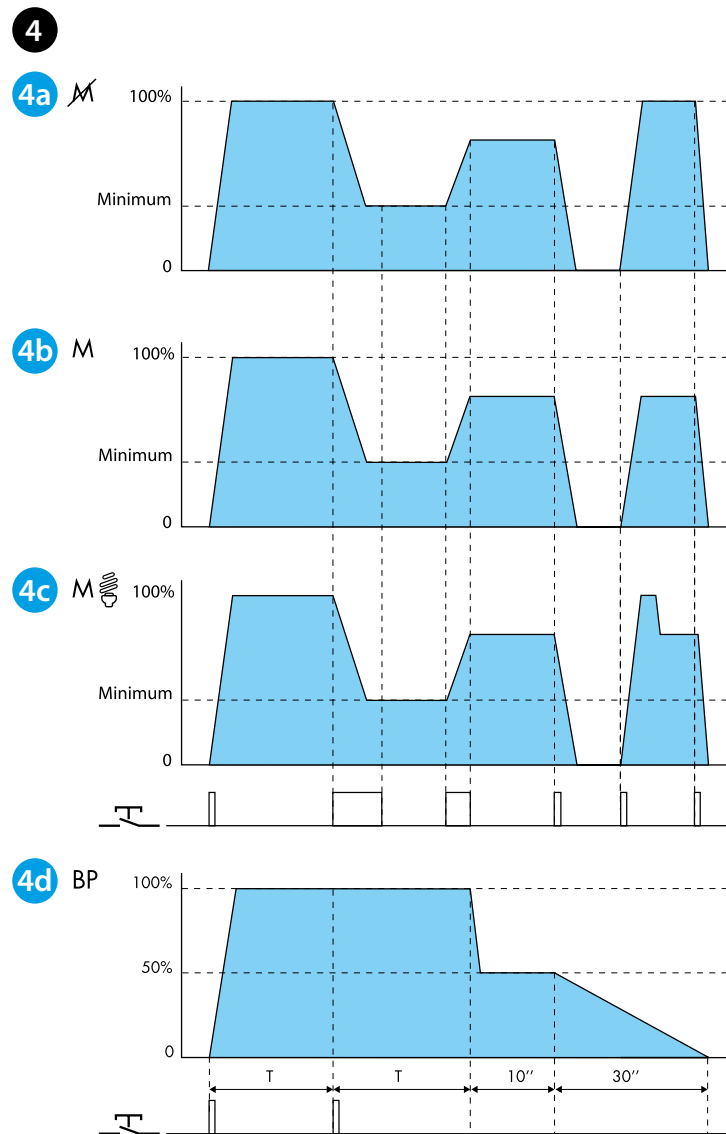
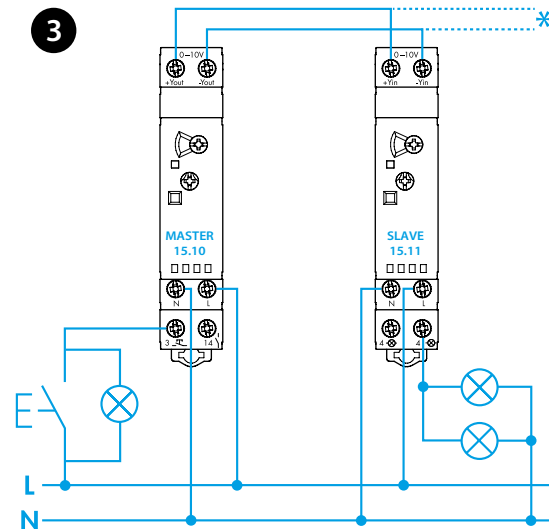
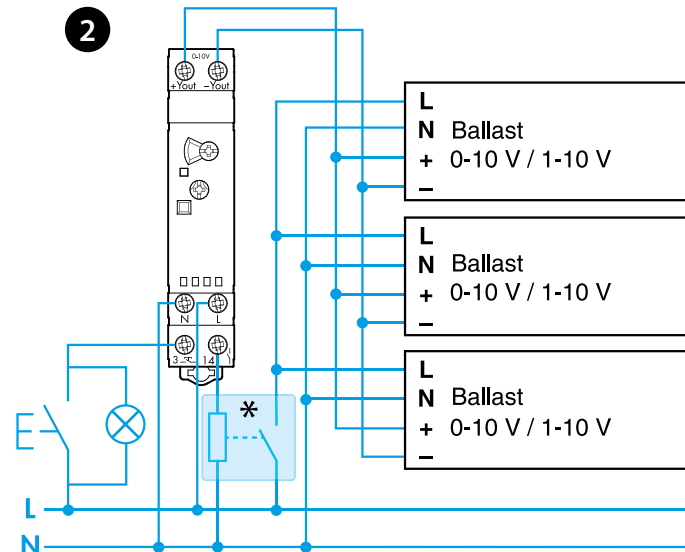
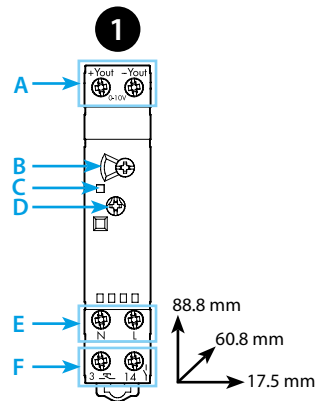

15.11.8.230.0400
 U_N 230 V AC (50 / 60 Hz)
IN 0-10 V (+Y_{in} / -Y_{in})
OUT 400 W
CFL - LED 100 W

ENGLISH

15.10 MASTER DIMMER

- 1 **FRONT VIEW**
A Output 0 - 10 V (+Y_{out} / -Y_{out})
B Function selector (4a - 4b - 4c - 4d)
C LED 5
D Selector:
- dimming speed: from 1.5 to 10 s
- timing (T): from 30s to 20min (BP function only 4d)
E Power supply U_N
F Command (3) - output contact (14)
- 2 **WIRING DIAGRAM**
15.10 Master Dimmer used with 0 - 10 V or 1 - 10 V electronic transformers or ballasts
Note: Maximum 15 illuminated push buttons linked into the line
*Check that the maximum Peak Current of the Ballast does not exceed the 30 A 230 V AC rating of terminal 14.
Use a contactor or power relay to switch loads exceeding this value

- 3 **CONFIGURATION (example)**
*Up to max 32 Slave Dimmer 15.11 connected 6
- 4 **FUNCTIONS**
4a (M) Dimming mode without Memory
4b (M) Dimming mode with Memory
4c (M) Dimming mode with Memory for CFLs Lamps
4d BP Staircase function with 50% early warning preceding dimming to 0%

- 5 **LED**
5a Standby (+Y_{out} / -Y_{out}) <1V
5b Live (+Y_{out} / -Y_{out}) ≥1V
5c Staircase function

- 6 **ACCESSORIES**
15.11.8.230.0400 Slave Dimmer

- NOTES**
- The output 0-10V (+Y_{out} / -Y_{out}) is isolated, overload and short circuit protected
- Output contact provides Live-out at terminal 14, only when Y_{out} ≥1V (used with 0 - 10 V / 1 - 10 V ballasts)