

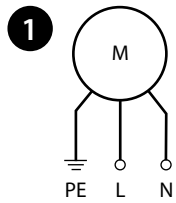

7F-3100

7F.x0.x.xxx.3100	
	U _N 120 V AC (50/60 Hz) (8.120)
	U _N 230 V AC (50/60 Hz) (8.230)
	U _N 24 V DC (9.024)
P _N 22 W (AC) / 9 W (DC)	
OUT	m ³ /h 100
	m ³ /h (+ 7F.0x) 75
	dB (A) 43 (AC) 45 (DC)
	(-10...+70)°C
	IP54



	max 2.5 mm ²
	0.8 Nm

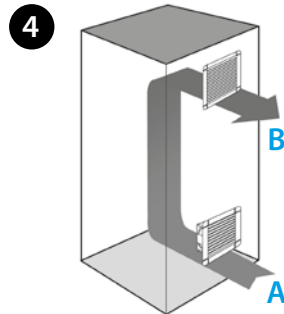
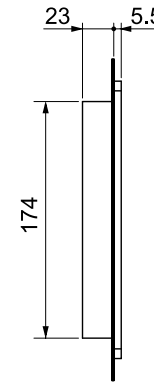
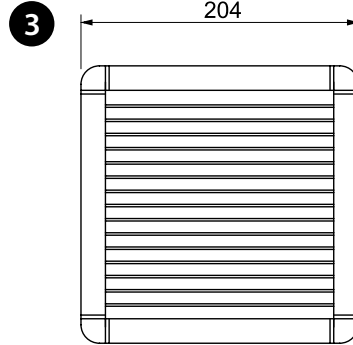
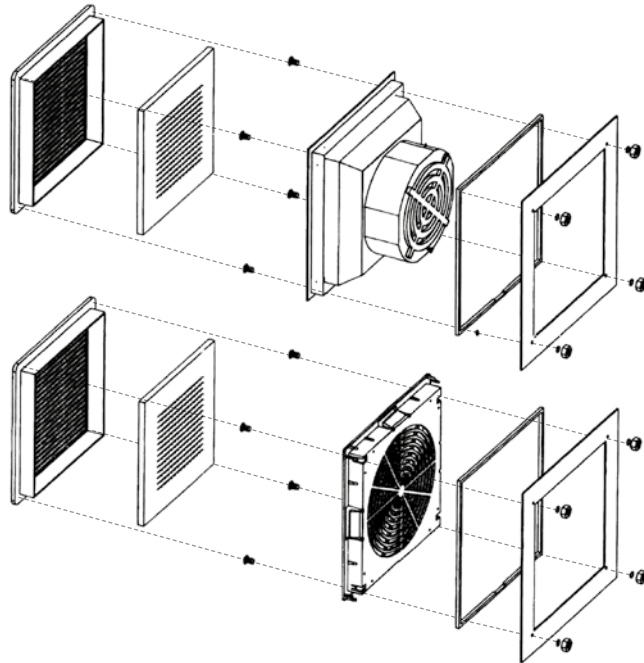
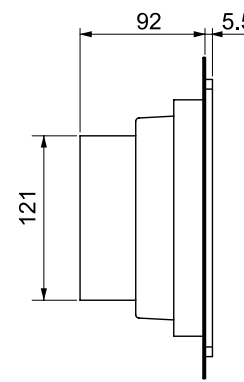
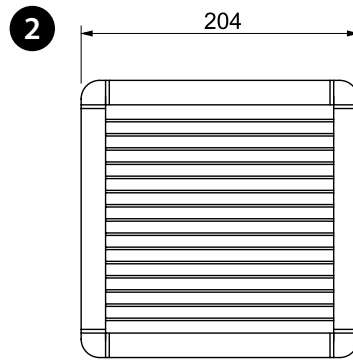

ENGLISH

7F FILTER FAN

1 WIRING DIAGRAM

2 OUTLINE DRAWING

3 ACCESSORIES

Exhaust Filter:

7F.05.0.000.3000 (for 7F.50)

7F.07.0.000.3000 (for 7F.70)

Filter mat:

07F.35

4 MOUNTING (example)

A filter fan

B exhaust filter

OTHER DATA

7F.50 Filter fan - for indoor use

7F.70 EMC filter fan - for indoor use

7F.80 Reverse flow filter fan - for indoor use

NOTE

The technical features (air volume, dimensions and electrical parameters) for the Standard Filter Fans (7F.50), the EMC filter fans (7F.70) and the Reverse flow versions (7F.80) - are exactly the same.

Filter mat class:

EU3 according to DIN 24185, filtering degree (80...90)%.

Filter material:

Synthetic fibre with progressive construction, temperature resistant to 100°C, self extinguishing, Class F1 (DIN 53438).

NOTE

By reversing the fan motor, the air direction can be changed from "Inlet" Filter Fan mode to "Exhaust" Filter Fan mode.