

BUCHER
hydraulics

Dyna-Lift[®]

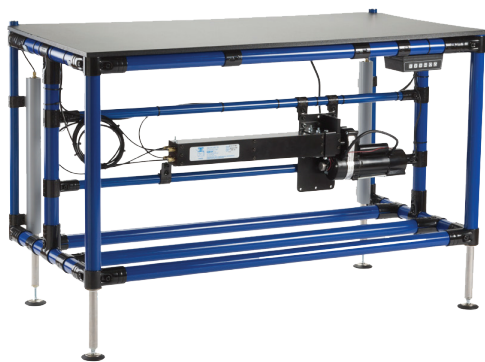

Find the right height for your application requirements

Ergonomic Height-Adjustable Systems



ISO 9001: 2015 Registered

We set the table for your requirements

Dyna-Lift® systems provide ergonomic solutions for workstation adjustability. When employees adjust their workstation with a Dyna-Lift®, it allows them to move throughout the day, from sitting to standing, which eliminates fatigue, pain, and potential injuries. Ergonomic, height-adjustable workstations provide the best posture solutions for multiple employees using the same workstation. Individual shift workers can use the same workstation and adjust it quickly to meet their specific height requirements and comfort.

Dyna-Lift® systems adjust a worktable, office furniture, lab equipment, industrial workbenches, hospital beds, assembly line fixtures, massage tables, podiums, rehabilitation tables, and so much more. As companies experience turnover, Dyna-Lift® will continue to adjust to meet new employee's height requirements without having to replace the system.

Dyna-Lift® systems are sturdy and can lift up to 1,500 lbs. Manufacturing, industrial, office, and medical environments use Dyna-Lift®.

Bucher Hydraulics recognizes there is a wide variety of customer needs. We can customize Dyna-Lift® systems to provide the smartest solution for your application.

Dyna-Lift® Systems

- Provide a long lasting solution
- Improve workers' productivity & comfort
- Avoid work related injuries
- Operate smoothly and quietly
- Comply with ADA and OSHA guidelines
- Install quickly
- Ship fully charged





Table of Contents

Ergonomic Solutions	4	External Extrusion Mount System	11
Pump & Cylinder Configurations	5	Telescopic Leg Assembly System	12 & 13
Standard Systems	6 & 7	System Selection Guide	14 & 15
Heavy-Duty Systems	8	Quick Ship Program	16
Inverted Motor System	9	Dimensions	16 & 17
Internal Extrusion Mount System	10	Parts & Accessories	18 & 19



Ergonomic Solutions



Standard Systems

250 lb (113 kg)/Cylinder Capacity
See pgs. 6 & 7

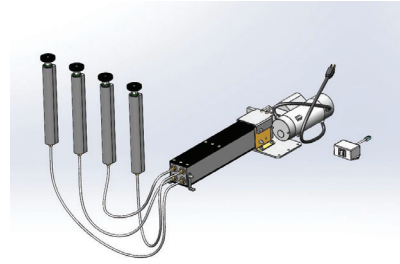

Heavy-Duty Systems

375 lb (170 kg)/Cylinder Capacity
See pg. 8



Inverted Motor System

250 lb (113 kg)/Cylinder Capacity
See pg. 9



Internal Extrusion Mount System

Up to 375 lb (170 kg)/Cylinder Capacity
See pg. 10



External Extrusion Mount System

Up to 375 lb (170 kg)/Cylinder Capacity
See pg. 11



Telescopic Leg System

Up to 375 lb (170 kg)/Cylinder Capacity/Column
See pgs. 12 & 13

Pump & Cylinder Configurations

Pump Schematics

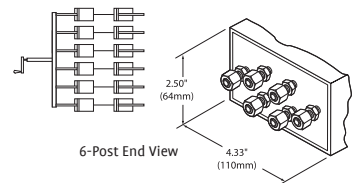
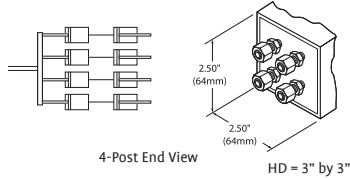
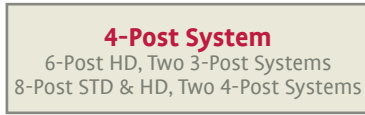
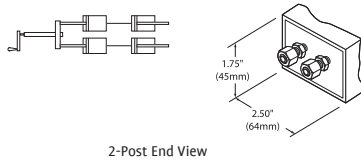

2-Post Pump Housing

Lift Cylinder Adj. Range Inch (mm)	"A" Length Inch (mm)	"B" Length Inch (mm)
6 (152)	11.96 (304)	11.12 (283)
8 (203)	13.99 (355)	13.15 (334)
10 (254)	16.02 (407)	15.18 (386)
12 (305)	18.05 (458)	17.21 (438)
16 (406)	22.12 (562)	21.28 (541)

4-Post Pump Housing

Lift Cylinder Adj. Range Inch (mm)	"A" Length Inch (mm)	"B" Length Inch (mm)
6 (152)	11.96 (304)	11.12 (283)
8 (203)	13.99 (355)	13.15 (334)
10 (254)	16.02 (407)	15.18 (386)
12 (305)	18.05 (458)	17.21 (438)
16 (406)	22.12 (562)	21.28 (541)

6-Post Pump Housing

Lift Cylinder Adj. Range Inch (mm)	"A" Length Inch (mm)	"B" Length Inch (mm)
6 (152)	12.15 (309)	11.40 (290)
8 (203)	14.18 (360)	13.43 (341)
10 (254)	16.21 (412)	15.48 (393)
12 (305)	18.24 (463)	17.49 (444)
16 (406)	22.31 (567)	21.56 (548)

Cylinder Options

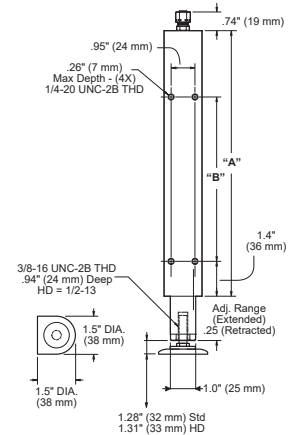
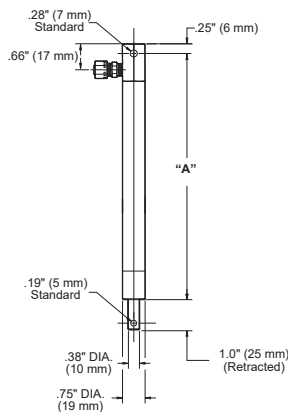
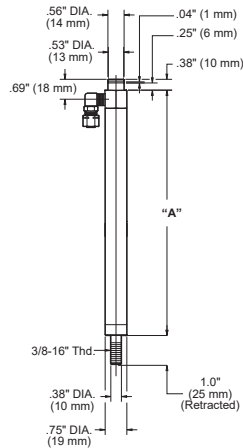
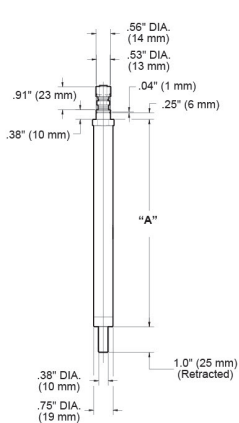

Cylinder Type A1A

Lift Cylinder Adj. Range Inch (mm)	"A" Inch (mm)
6 (152)	8.38 (213)
8 (203)	10.38 (264)
10 (254)	12.38 (314)
12 (305)	14.38 (365)
16 (406)	18.38 (467)
20 (508)	22.38 (568) HD Only

Cylinder Type B2D

Lift Cylinder Adj. Range Inch (mm)	"A" Inch (mm)
6 (152)	8.75 (222)
8 (203)	10.75 (273)
10 (254)	12.75 (324)
12 (305)	14.75 (375)
16 (406)	18.38 (476)
20 (508)	22.75 (578) HD Only

Cylinder Type C1C

Lift Cylinder Adj. Range Inch (mm)	"A" Inch (mm)
6 (152)	8.88 (226)
8 (203)	10.88 (276)
10 (254)	12.88 (327)
12 (305)	14.88 (378)
16 (406)	18.88 (480)
20 (508)	23.25 (591) HD Only

Cylinder Type D1A & 20" D1D

Lift Cylinder Adj. Range Inch (mm)	"A" Inch (mm)	"B" Inch (mm)
6 (152)	11.50 (292)	6.50 (165)
8 (203)	13.50 (343)	9.45 (240)
10 (254)	15.50 (394)	9.45 (240)
12 (305)	17.50 (445)	13.38 (340)
16 (406)	21.50 (546)	13.38 (340)
20 (508)	25.50 (648)	17.38 (442) HD Only

Standard Systems (S)

Advantages

- Lifts up to 1,000 lbs. (454 kg)
- Rechargeable and fully serviceable in the field

General Description

- Complete, ready-to-install, height-adjustable system
- Choose from 1 to 8 cylinders
- Manual or electric operation
- Custom systems available

Technical Information

- System capacity:
 - 250 lbs. (113 kg) per cylinder for Standard
 - 1,000 lbs. (454 kg) max. total capacity on Standard
- System ships fully charged and ready-to-install
- Smooth, quiet operation
- Highly refined white hydraulic fluid
- Powder-coated housing finish



Standard Manual



Standard Electric

2-Post & 4-

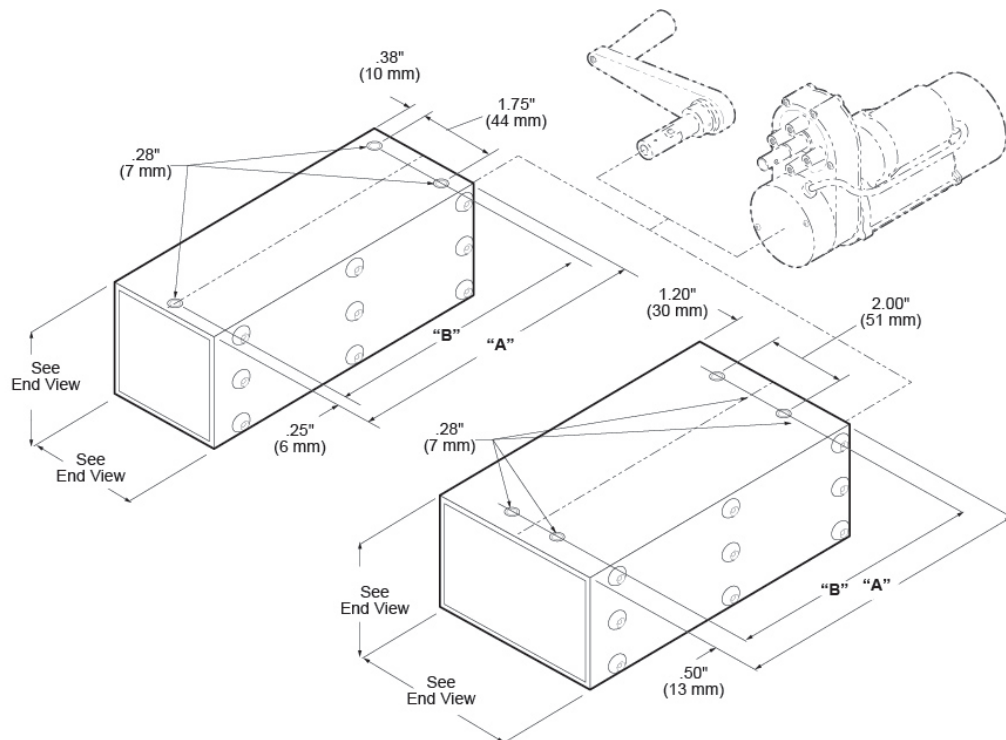

For "A" & "B" refer to charts on pg. 7

Standard Manual Pump Assembly

- Retractable handle
- Five revolutions per inch travel
- 2-Post Manual System with 16-inch stroke cylinder weighs 10 lbs. (4.54 kg)
- 4-Post Manual System with 12-inch stroke cylinder weighs 27 lbs. (12.25 kg)

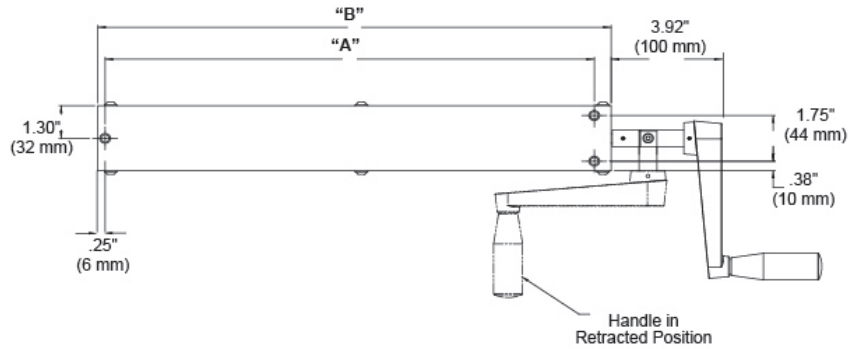

Standard Manual Pump

Standard Manual Specifications

Stroke Inch (mm)	"A" Inch (mm)	"B" Inch (mm)
6 (152)	11.12 (282)	11.96 (304)
8 (203)	13.15 (334)	13.99 (355)
10 (254)	15.18 (386)	16.02 (407)
12 (305)	17.21 (437)	18.05 (458)
16 (406)	21.28 (541)	22.12 (562)

Standard Electric Pump Assembly

- Low voltage safety switch
- Internal limit switches
- Thermal overload protection
- UL recognized CSA certified
- 6-Post Electric System with 12-inch stroke cylinder weighs 72 lbs. (32.69 kg)

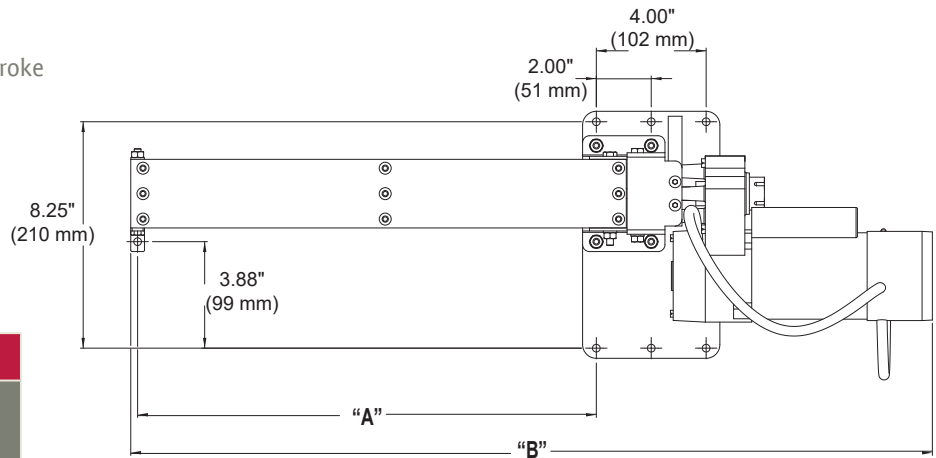

Standard Electric Pump

Standard Electric Specifications

Stroke Inch (mm)	"A" Inch (mm)	"B" Inch (mm)
6 (152)	10.62 (270)	23.18 (589)
8 (203)	12.65 (321)	25.21 (640)
10 (254)	14.68 (373)	27.24 (691)
12 (305)	16.71 (424)	29.27 (744)
16 (406)	20.78 (528)	33.34 (847)

Heavy-Duty Systems (H)

Advantages

- High capacity with longer stroke
- Rechargeable and fully serviceable in the field
- 2:1 pump to cylinder ratio

General Description

- Converts fixed height structure to one with a 0-20" range of height adjustment
- Manual or electric operation
- Retrofit & OEM applications
- Custom systems available

Technical Information

- System capacity:
 - 375 lbs. (170 kg) per cylinder for Heavy-Duty
 - 1,500 lbs. (680 kg) max. capacity on Heavy-Duty
- System must be guided
- System ships fully charged and ready-to-install
- Smooth, quiet operation
- Highly refined white hydraulic fluid
- Powder-coated housing finish

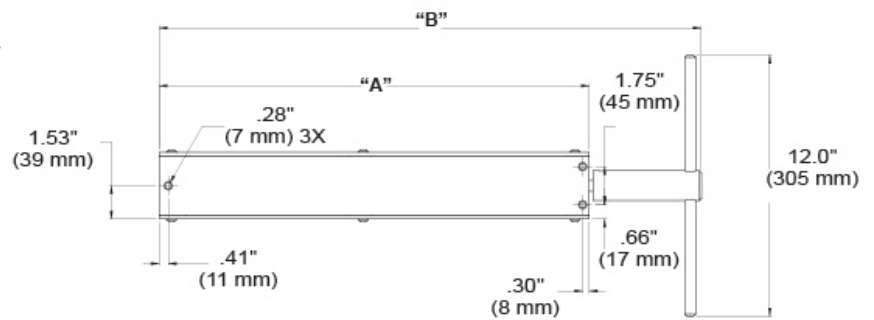
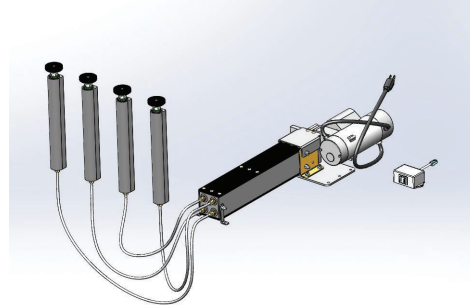

Heavy-Duty Manual

Manual Specifications		
Stroke Inch (mm)	"A" Inch (mm)	"B" Inch (mm)
6 (152)	15.75 (400)	20.91 (531)
8 (203)	15.75 (400)	20.91 (531)
10 (254)	19.80 (503)	24.97 (634)
12 (305)	19.80 (503)	24.97 (634)
20 (508)	27.92 (709)	33.09 (804)

Electric Specifications		
Stroke Inch (mm)	"A" Inch (mm)	"B" Inch (mm)
6 (152)	14.65 (372)	28.48 (723)
8 (203)	14.65 (372)	28.48 (723)
10 (254)	18.71 (475)	32.54 (827)
12 (305)	18.71 (475)	32.54 (827)
20 (508)	26.85 (682)	40.35 (1025)

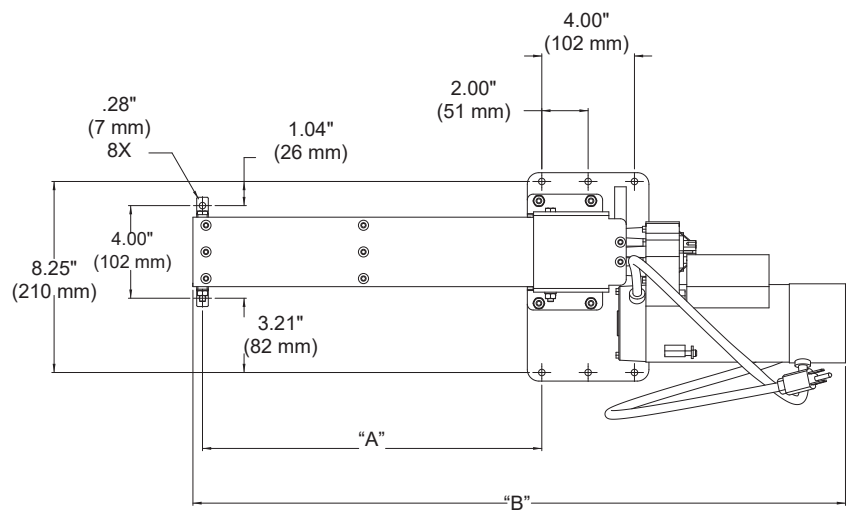

Heavy-Duty Electric

Inverted Motor System (INV)

Advantages

- Ideal where space is limited
- 6-1/8 inches shorter overall length than Standard
- Same cylinder configurations available as Standard

General Description

- 4-cylinder configuration
- Inverted motor
- Short pump

Technical Information

- Extruded aluminum
- Adjustment ranges available: 6", 8", 10", 12", 16"
- Lifting capacity: 1,000 lbs. (454 kg)
- Lifting capacity per cylinder: 250 lbs. (113 kg)
- Electric actuation only
- 4-Cylinder only

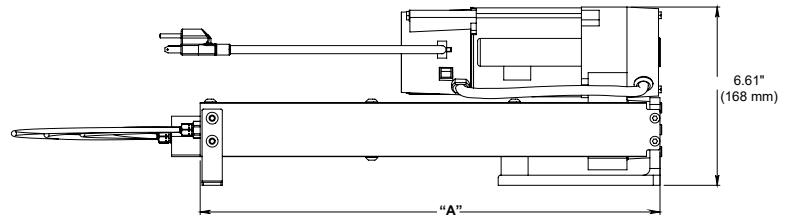

Inverted Motor System

Inverted Motor Specifications		
Stroke Inch (mm)	"A" Inch (mm)	"B" Inch (mm)
6 (152)	17.06 (433)	11.73 (298)
8 (203)	19.09 (485)	13.77 (350)
10 (254)	21.13 (537)	15.80 (401)
12 (305)	23.16 (588)	17.83 (453)
16 (406)	27.23 (692)	21.90 (556)

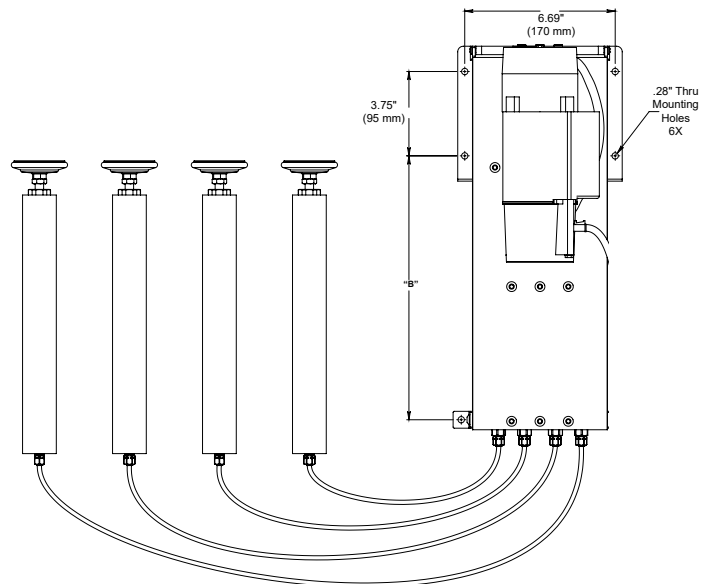

Internal Extrusion Mount System (S6... & H6...)

Advantages

- Internally mounted cylinder neatly hides away unwanted outside obstructions – no external hardware

General Description

- Perfect application for OEM's and custom machine builders

Technical Information

- Adjustment ranges available in: 6", 8", 10", and 12" stroke
- Lifting capacity up to 1,500 lbs. on Heavy-Duty
- Single acting cylinders, power up and gravity down
- Approximately 30 lbs. of weight per cylinder needed to retract properly
- Manual with hand crank or electric actuation available
- Internal cylinder mount available for:
 - 80/20 extrusions 3030
 - 80/20 extrusions 8080
 - Bosch extrusions 80mm
 - Bosch extrusions 90mm



Contact Bucher Sales for Additional Manufacturers' Extrusions



Internal Extrusion Mount Leg

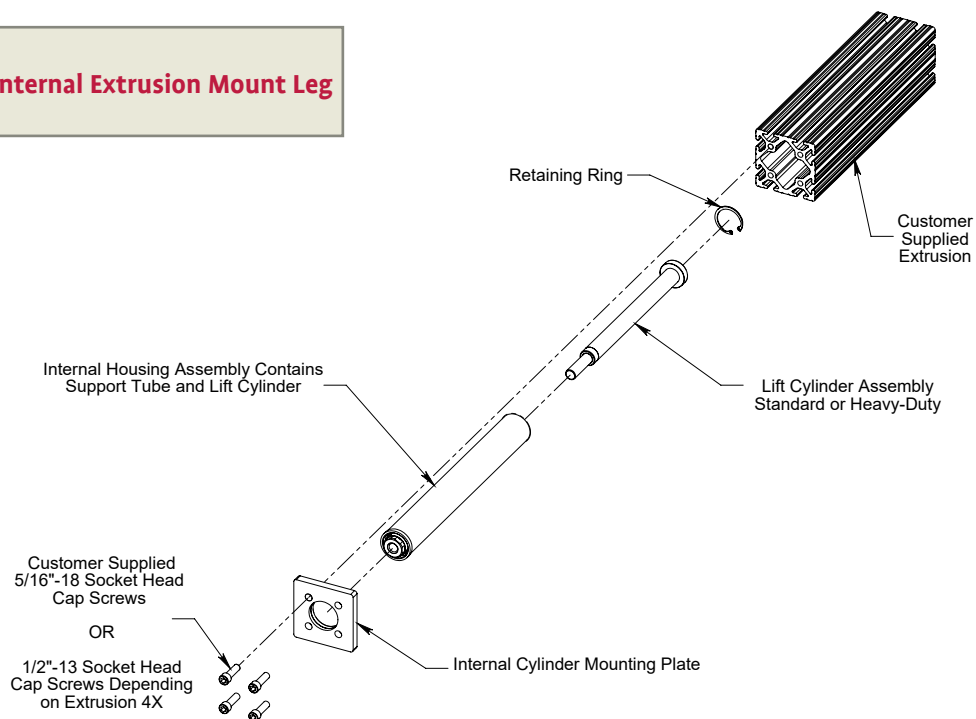

External Extrusion Mount System

Advantages

- Universally fits many different sizes of extruded aluminum structures via T-Slot
- Easy installation as an OEM design or as an add-on retrofit to a pre-existing structure

General Description

- Retrofit the “D” style cylinder to many different size extrusions via the “L” bracket
- “L” bracket universally fits different sizes of extrusion via the T-Slot
- Tighten down bracket to T-Slot with an Allen wrench

Technical Information

- Adjustment ranges available in: 6”, 8”, 10”, 12”, 16” and 20” stroke
- Lifting capacity up to 1,500 lbs.
- Single acting cylinders, power up and gravity down.
- Approximately 30 lbs. of weight per cylinder needed to retract properly
- Manual hand crank or electric actuation available



Optional "L" Bracket easily mounts Standard & Heavy-Duty Systems for external extrusion applications.

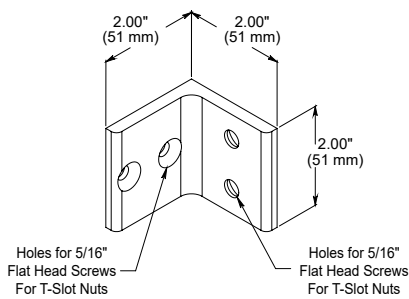

"L" Bracket

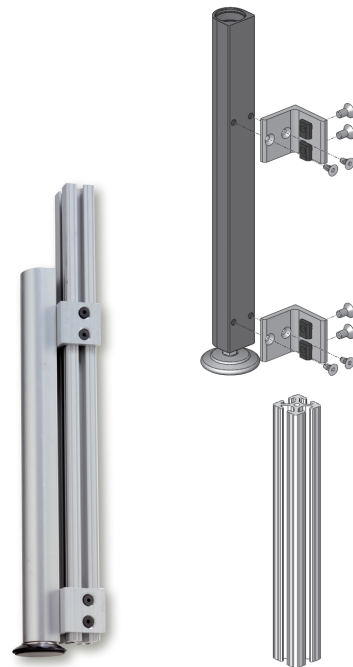

External Extrusion Mount Leg

Telescopic Leg Systems (T/T12)

Advantages

- Provides optimum form & function
- Easy-to-clean, smooth, extrusion surface - just hose down
- Steady, quiet, height adjustability
- OEMs integrate columns into custom applications

General Description

- Two-piece anodized aluminum extrusions
- Easy and quick installation

Technical Information

- Extruded aluminum with clear matte anodized finish
- Standard column height is 24" (610 mm); maximum adjustment range is 12" (305 mm)
- System height fully retracted is 24" (610 mm)
- System height fully extended is 36" (914 mm)
- For additional column heights and available strokes, please contact Bucher Sales at +1 (616) 458-1306
- System capacity:
 - 250 lbs. (113 kg) or 375 lbs. (170 kg) per column
 - 500 lbs. (227 kg) per set of two columns
 - 750 lbs. (340 kg) per set of two columns for HD
- Designed to be used with B1C cylinders
- Manual (hand crank) or electric actuation



Telescopic Manual Leg



Telescopic Electric Leg



Telescopic Leg Specifications			
Stroke Inch (mm)	"A" Inch (mm)	"B" Inch (mm) Fully Retracted	"B" Inch (mm) Fully Extended
12 (305)	24 (60)	24 (610)	36 (915)

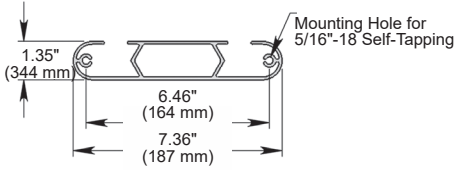
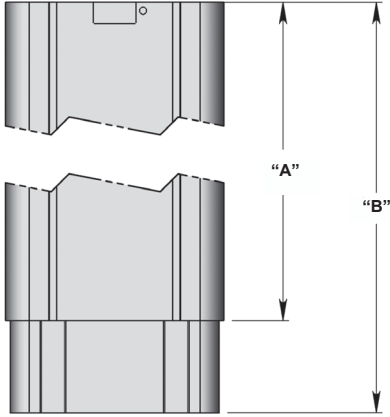
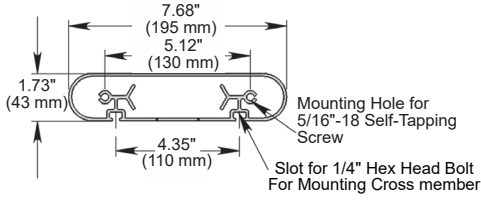

Exterior View



Interior View



Internal View

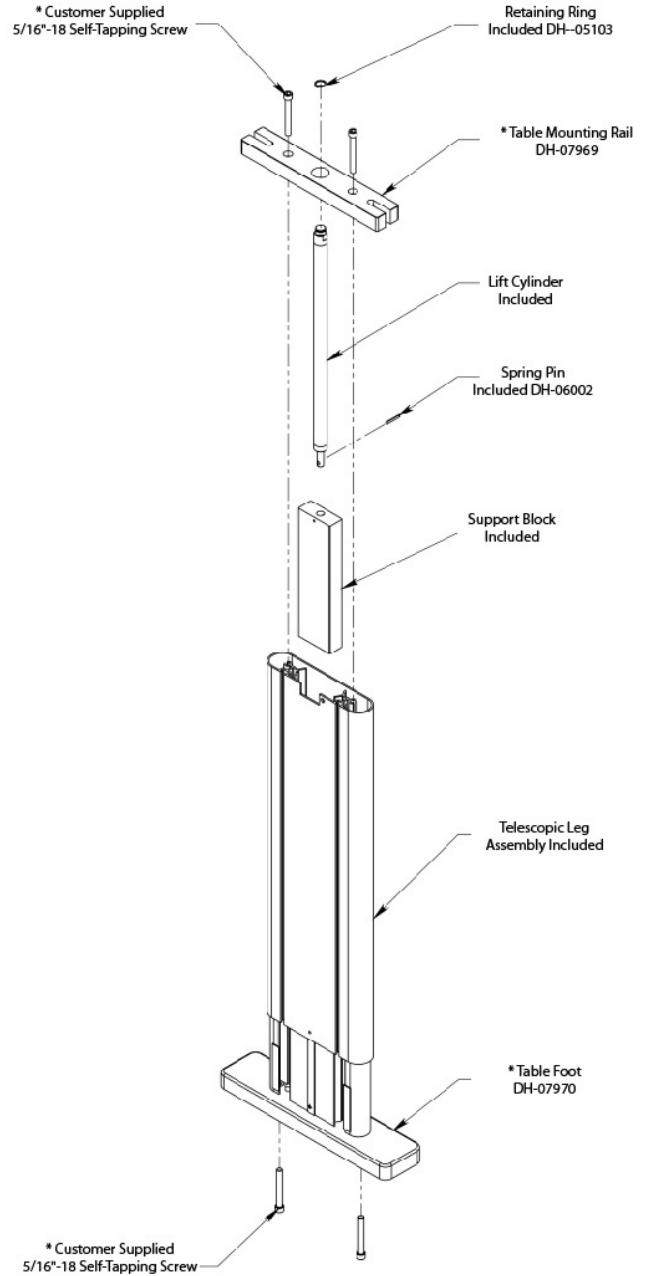

* Optional spare parts not included. See pgs. 18 & 19.

System Selection Guide

Ex. 4E-D1A-12-S

4













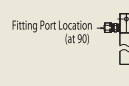
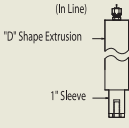





E

—

D

1

A

# of Cyl.	Actuator Type	Cylinder Body Type	Cylinder / Pump Fitting Type	Live End Rod Type
1	M = Manual Crank Drive	 <p>A = In-line Tubing Port/External Retaining Ring Mount (Cylinder Tube End)</p>  <p>B = 90° Tubing Port/External Retaining Ring Mount (Cylinder Tube End)</p>  <p>C = 90° Tubing Port/External Clevis Mount (Cylinder Tube End)</p>  <p>D = In-line Tube Port/A-Style Cylinder Mounted Inside 1" Support Sleeve, Inside 1.5" x 1.5" D-Shaped Housing with (4) 1/4-20" Mounting Holes. Requires No External Guide Support.</p> <p>(See pg. 5 for typical cylinder configurations)</p>  <p>E = Internal Mount Other</p>  <p>3 = Internal Mount for 3" x 3" Extrusion with 1" Support Sleeve, Foot Glide, Internal Bushing and End Cap</p>  <p>8 = Internal Mount for 80 mm x 80 mm Extrusion with 1" Support Sleeve, Foot Glide, Internal Bushing and End Cap</p>  <p>9 = Internal Mount for 90 mm x 90 mm Extrusion with 1" Support Sleeve, Foot Glide, Internal Bushing and End Cap</p> <p>(See pg. 10 for internal mount cylinders)</p>	 1 = Straight / Straight  2 = 90° / Straight  3 = Straight / 90°  4 = 90° / 90°  5 = 180° / Straight  6 = 180° / 90°  7 = Straight Velocity Fuse / Straight  8 = Straight Velocity Fuse / 90°	<p>Guided "D" Rod End Options</p> <p>A = 3/8" Adapter w/ 3/8" Foot Glide</p> <p>B = 3/8" Adapter w/o Foot Glide</p> <p>C = 1/2" Adapter w/ 1/2" Caster</p> <p>D = 1/2" Adapter w/ 1/2" Foot Glide</p> <p>E = 1/2" Adapter w/o Foot Glide</p> <p>F = 3/8" SS Adapter, 3/8" SS Foot Glide w/ SS Piston Rod</p> <p>G = 1/2" SS Adapter, 1/2" SS Foot Glide w/ SS Piston Rod</p> <p>Unguided Rod End Options</p> <p> A = Straight Rod End</p> <p> B = Retainer Ring Rod End</p> <p> C = Clevis Rod End</p> <p> D = Threaded Rod End</p>
2	N = No Motor / Handle			
3	E = 115 VAC* (60 Hertz)			
4	2 = 220 VAC* (50 Hertz)			
5	3 = 12 VDC			
6	4 = 24 VDC			
8	5 = 115 VAC* High Speed			
	P = Programmable Switch			
	*AC motors include a rocker switch; DC motors do not.			



Cylinder Adjustment Range Inches (mm)

Standard or Custom

Optional Tubing Lengths

06 (156)	S = Standard
08 (203)	H = Heavy-Duty 1,500 lb. Capacity
10 (254)	T = Telescopic Leg System (w/ B1C Leg Cylinder only)
12 (305)	T12 = Telescopic Leg System (w/ mounting rails and feet)
16 (406) **STD Only**	M = Mobile Battery Operated
20 (508) **4-Post HD Only**	INV = Inverted Motor + Pump System (Electric Actuation only)
	S62B = Standard, Internal Mount, Bosch Extrusion
	S62E = Standard, Internal Mount, 80/20 Extrusion
	H62B = Heavy-Duty, Internal Mount, Bosch Extrusion
	H62E = Heavy-Duty, Internal Mount, 80/20 Extrusion

Specify Tube Length from Pump to Cylinder

- Cyl. # 1 _____
- Cyl. # 2 _____
- Cyl. # 3 _____
- Cyl. # 4 _____
- Cyl. # 5 _____
- Cyl. # 6 _____

Example Tube Lengths

- 2 cyl. = 96".60"
- 4 cyl. = 96".96".60".60"
- 6 cyl. = 120".120".120".96".96".96"

Max. Recommended Tube Length is 144"

Quick Ship Program

Advantages

- Standard systems
- Ships typically in 1 to 5 business days



Standard Manual Systems			
Description	Model #	Shipping Dimensions Inch.	Shipping Weight Lbs.
4-Cylinder, 06" Stroke	4M-DIA-06-S	27x9x7	20
4-Cylinder, 08" Stroke	4M-DIA-08-S	27x9x7	23
4-Cylinder, 10" Stroke	4M-DIA-10-S	37x9x8	27
4-Cylinder, 12" Stroke	4M-DIA-12-S	37x9x8	30
4-Cylinder, 16" Stroke	4M-DIA-16-S	37x9x8	35

Standard Electric Systems			
Description	Model #	Shipping Dimensions Inch.	Shipping Weight Lbs.
4-Cylinder, 06" Stroke	4E-DIA-06-S	27x9x7	35
4-Cylinder, 08" Stroke	4E-DIA-08-S	27x9x7	37
4-Cylinder, 10" Stroke	4E-DIA-10-S	37x9x8	40
4-Cylinder, 12" Stroke	4E-DIA-12-S	37x9x8	42
4-Cylinder, 16" Stroke	4E-DIA-16-S	37x9x8	48

Dimensions

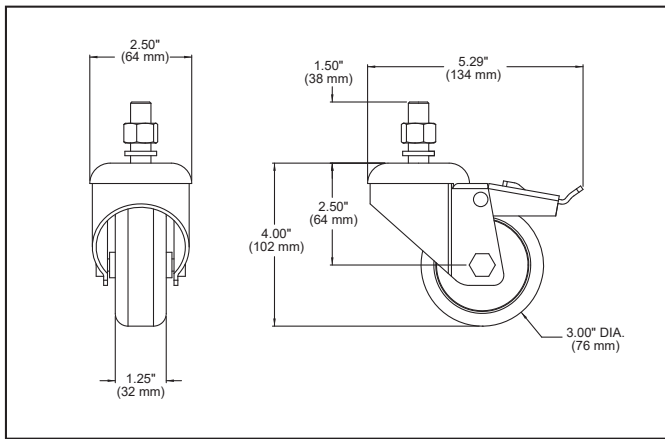

Standard Caster

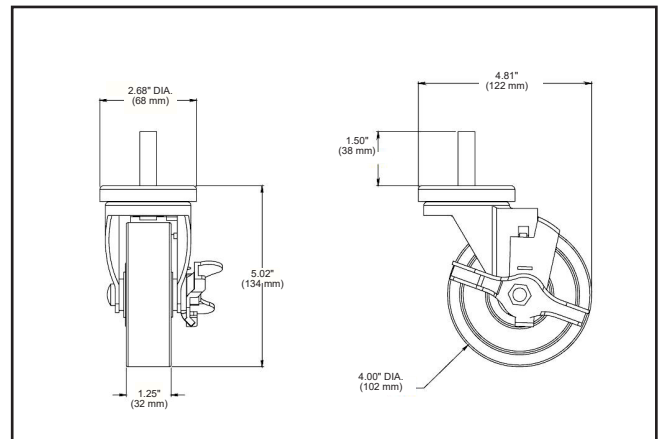

Heavy-Duty Caster

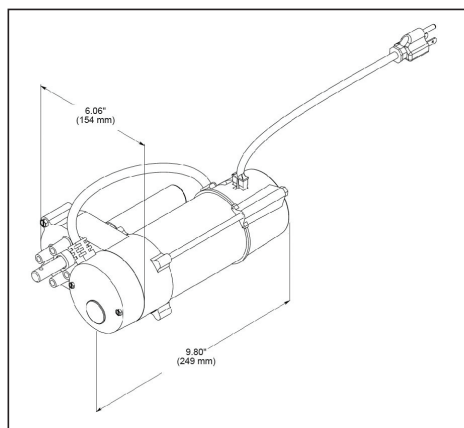

AC Motor

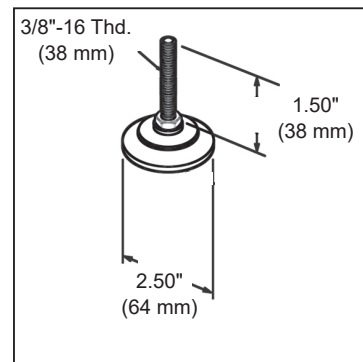

Foot Glide 4-Post Standard System

Dimensions

**Rocker Switch Housing
Standard w/ AC
Electric System**

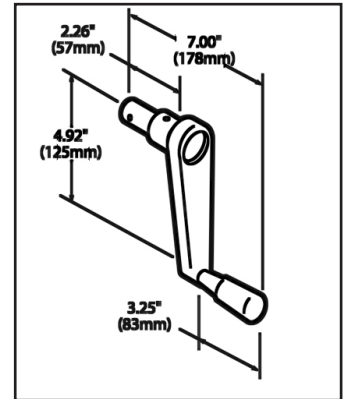
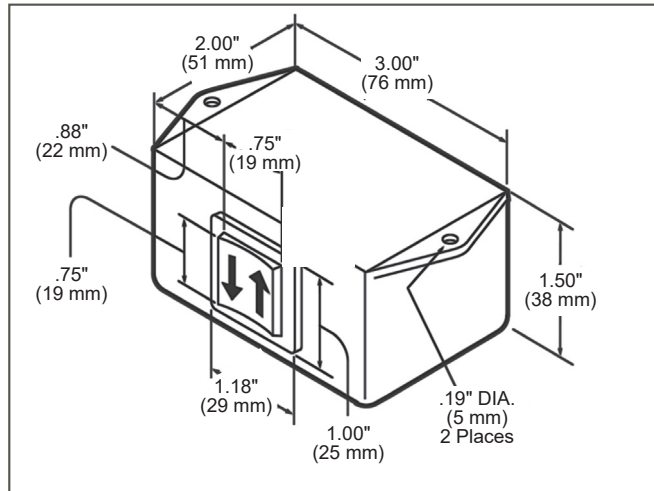

**Retractable Folding Handle
Standard w/ Manual System**

**Foot Pedal
Option w/ Electric System**

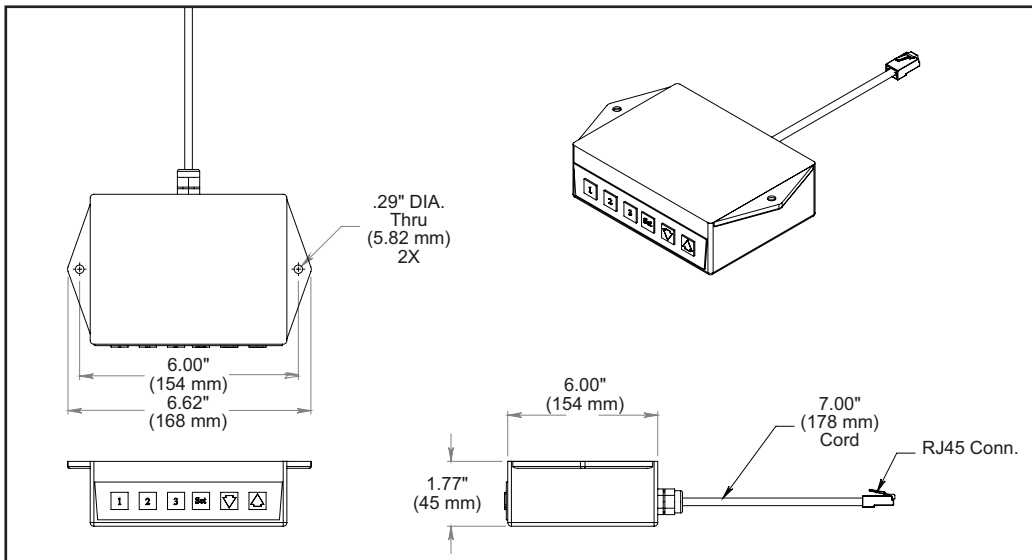
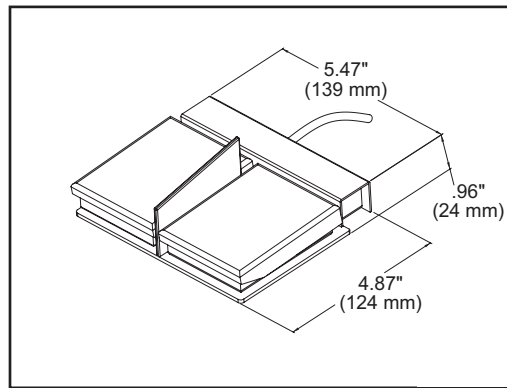

**Programmable Switch
Designated Motors Only**

Please consult Bucher Sales with specific requirements.

Parts & Accessories



DL Gear Motor 115 VAC
#DH-07000



DL Gear Motor 24 VDC
#DH-07005



Standard Caster
#DH-17203



Heavy-Duty Caster
#DH-17206



3/8" CS STD Foot Glide
#DH-17200



3/8" SS STD Foot Glide
#DH-17208



1/2" CS HD Foot Glide
#DH-17202



1/2" SS HD Foot Glide
#DH-17207



Standard Adapters

3/8" rod x 3/8" THD CS #DC-03000
3/8" rod x 3/8" THD SS #DC-03002
3/8" rod x 1/2" THD CS #DC-03004
3/8" rod x 1/2" THD SS #DC-03006

Heavy-Duty Adapters

1/2" rod x 3/8" THD CS #DC-03001
1/2" rod x 3/8" THD SS #DC-03003
1/2" rod x 1/2" THD CS #DC-03005
1/2" rod x 1/2" THD SS #DC-03012



SAE Straight Fitting
STD #DH-04111
HD #DH-04113



SAE 90° Fitting
STD #DH-04202
HD #DH-04203



NPT Straight Fitting
STD #DH-04100
HD #DH-04101

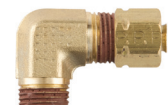

NPT 90° Fitting
STD #DH-04200
HD #DH-04201

Parts & Accessories



180° Standard Fitting
#DH-04110



180° Heavy-Duty Fitting
#DH-04112



"L" Bracket
#DH-08000



Heavy-Duty Handle
#DH-06517



STD Retractable Handle
#DH-17100



Programmable Switch
Designated Motors Only
#DH-08414



Foot Pedal
#DH-08405



Rocker Switch
#DH-08400



T.L.A Column
Contact Bucher Sales



Standard Recharge Kit
#DH-16000



Heavy-Duty Recharge Kit
#DH-16002



Friction Modifier Kit
#DH-16001

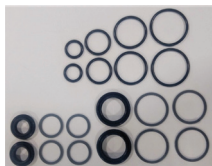

Seal Kits 2- & 4-Post
#DH-16100
#DH-16101



Fill & Plug Pump
#DP-10010



Power Cords
230 VAC #DH-08419
115 VAC #DH-08420



STD & HD Tubing
STD #DH-04600
HD #DH-04650



BUCHER
hydraulics

info@bucherhydraulics.com
www.bucherhydraulics.com
www.dynalift.com

Bucher Hydraulics, Inc. 500-FL-000010-EN-08/06.2019
We reserve the right to implement changes without prior notice